

राष्ट्रीय डिजाइन संस्थान  
NATIONAL INSTITUTE OF DESIGN

Design  
Programme

B. Des  
M. Des

डिजाइन क्वेस्ट

Dezine Quest®

TIME- 3 HRS

TOTAL MARKS- 100

DATE- \_\_\_\_\_

We inspire, create and publish your dream

NAME : \_\_\_\_\_

Roll No.

BATCH A

BATCH B

BATCH C

BATCH D

BATCH E

CRASH COURSE

TARGET

TEST SERIES

DAT - SAMPLE PAPER - 2023

**Instructions :**

1. Read the directions properly and carefully. Read twice, thrice till you get to understand the questions.
2. Go through details of every question most of the times answers are hidden inside the questions.
3. Choose the current option in MCQ
4. Mark correct answers of MCQs in OMR. There shall be negative marking
5. Use colours where ever possible, until and unless it is restricted to do so. (At least in one question)
6. Maximum marks shall be awarded to neat, fresh and raw ideas.
7. Marks shall be allotted on the basis of observation, visualization, innovation and execution respectively..
8. Try to communicate in simple language to make it completely self-explanatory.

**Marking Parameters: 50%- Idea/Concept 30%- Excution of Idea 20%- Neatness and Presentation**

BY NIIFTIANS NIIFT BY NIIFTIANS NIIFT

TEST SERIES - THE LAUNCH PAD

BY NIIFTIANS NIIFT BY NIIFTIANS NIIFT

QUESTIONS	MARKS	ATTENDED	OBTAINED	REMARKS
<input type="text"/>	<input type="text"/>	<input type="text"/>	<input type="text"/>	<input type="text"/>

QUESTIONS	MARKS	ATTENDED	OBTAINED	REMARKS
<input type="text"/>	<input type="text"/>	<input type="text"/>	<input type="text"/>	<input type="text"/>

**To get an appointment for Feedback and Guidance - 7070708866**

Faculty Signature

Parents Feedback

Parent Signature

Question Numbers 1 to 17 consist of 01 Mark each.

Q1. Lovlina Borgohain won Olympics bronze in which sport?

(A) Tennis (B) Wrestling

(C) Football (D) Boxing

Q2. Which of the following is a dance form of Meghalaya?

(A) Laho (B) Dalkhai

(C) Cheraw (D) Rangma

Q3. Which Indian state has approved the formation of a Special Tiger Protection Force?

(A) Arunachal Pradesh (B) Assam

(C) Nagaland (D) Sikkim

Q4. In a certain code DESIGN is written as FCUGIL, How is REPORT written in that code?

(A) TCRMCR (B) TCRMTR

(C) TCTMPR (D) TCTNTR

Q5. Count the number of triangles and squares in the given figure.

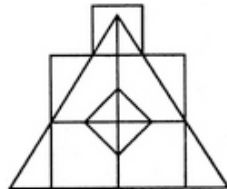

(A) 21 triangles, 7 squares (B) 22 triangles, 7 squares

(C) 20 triangles, 8 squares (D) 18 triangles, 8 squares

Q6. Which is the color with the highest wavelength?

(A) Red Color (B) White Color

(C) Black Color (D) Violet color

Q7. Ustad Bismillah Khan is related to which instrument?

(A) Shehnai (B) Bansuri

(C) Tabla (D) Sitar

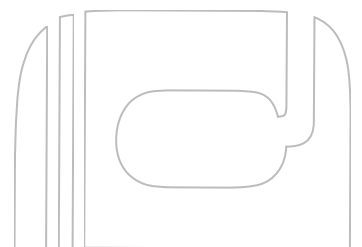
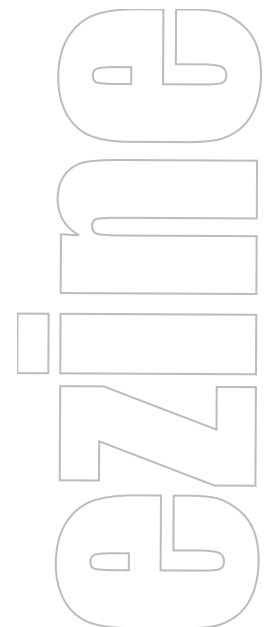

Q8. Why does a prism split white light into different colors?

- (A) Different colours have different wavelengths
- (B) Different colours have different wavelengths and the more wavelength a colour has , the less it bends.
- (C) Different colours have different wavelengths and the less wavelength a colour has , the more it bends.
- (D) None of these

Q9. Which state has been declared as the organic state in India?

- (A) Sikkim
- (B) Karnataka
- (C) Manipur
- (D) Chennai

Q10. Where will the 2024 Olympics be taking place?

- (A) Tokyo
- (B) London
- (C) Paris
- (D) Athens

Q11. Full form of NITI Aayog?

- (A) National Institution for Transforming India
- (B) New Institution for Transforming India
- (C) National Institution of Transforming India
- (D) New Institution for Transformation of India

Q12. In which year was the Nation Education Policy recently updated?

- (A) 2021
- (B) 2022
- (C) 2023
- (D) 2020

Q13. Which Indian movie won awards with no dialogues?

- (A) Birat Ferat
- (B) Siraz
- (C) Pushpaka Vimana
- (D) Bhakta Vidur

Q14. A clock is so placed that at 12 noon its minute hand points towards North-East. In which direction does its hour hand point at 1:30 pm?

- (A) North
- (B) South
- (C) East
- (D) West

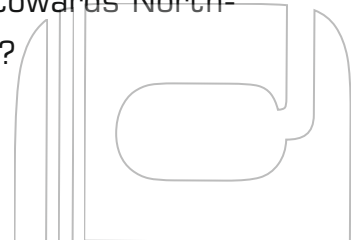
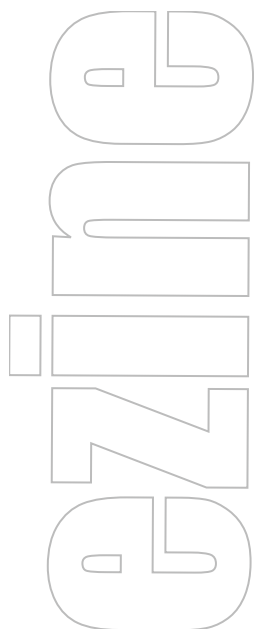
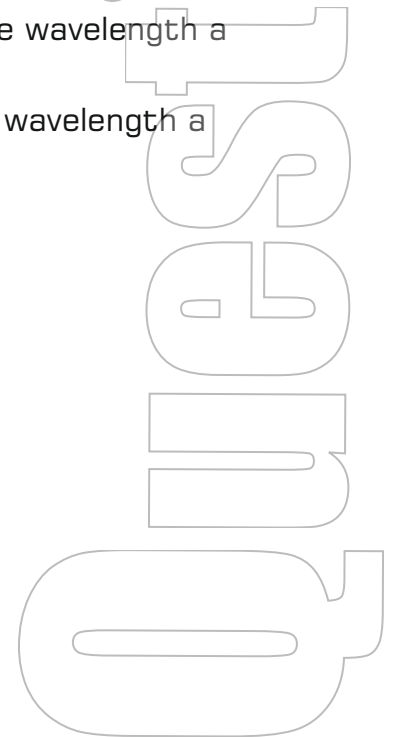

Q15. Select the right set of pattern that corresponds correctly to the set of four embroidery given below.



(A)



(B)



(C)



(D)

- A) Kashida embroidery, Sujini embroidery, Zari embroidery, Chikankari embroidery
- B) Chikankari embroidery, Zari embroidery, Sujini embroidery, Kashida embroidery
- C) Zari embroidery, Chikankari embroidery, Kashida embroidery, Sujini embroidery
- D) Sujini embroidery, Kashida embroidery, Chikankari embroidery, Zari embroidery,

Q16. Choose the box that is similar to the box formed from the given sheet of paper (X).

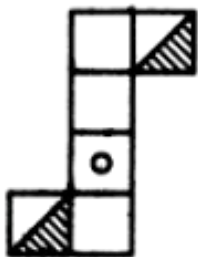

(X)



(1)



(2)



(3)



(4)

- (A) 1 and 3 only
- (C) 2 and 4 only

- (B) 1 and 4 only
- (D) 3 and 4 only

Q17. Ikebana the classical art of flower arranging is from which country-

- A) Japan
- B) China
- C) Korea
- D) Russia



Question Numbers 18 to 19 consist of 02 Mark each.

Q18. Identify the top view of the below given component.

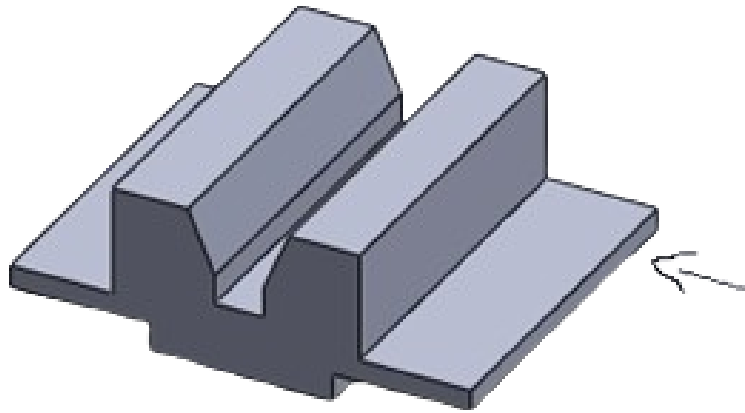

(A)

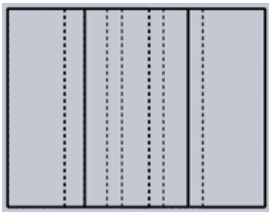

(B)

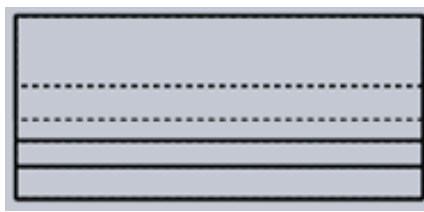

(C)

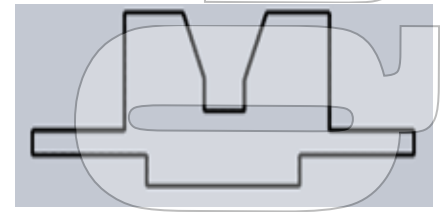

(D)

Q19. Choose a box that is similar to the box formed from the given sheet of paper.

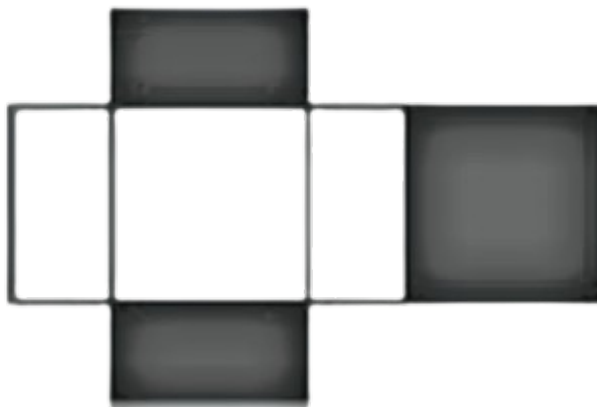

(A)



(B)

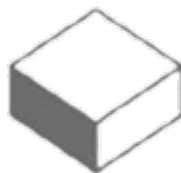

(C)

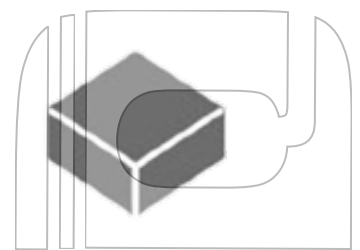

(D)

Directions (Questions 20 to 24): Read the following paragraph to answer these questions:

**5 Marks**

Corruption is not a new phenomenon in India. It has been prevalent in society since ancient times. History reveals that it was present even in the Mauryan period. Great scholar, Kautilya, mentions the pressure of forty types of corruption in his contemporary society. It was practiced even in the Mughal and Sultanate period. When the East India Company took control of the country, corruption reached a new height. Corruption in India has become so common that people now are averse to thinking of public life with it.

Corruption has been defined variously by scholars. But the simple meaning of it is that corruption implies perversion of morality, integrity, character or duty out of mercenary motives, i.e. bribery, without any regard to honor, right, and justice. In other words, undue favor for anyone for some monetary or other gains is corruption. Simultaneously, depriving the genuinely deserving of their right or privilege is also a corrupt practice. Shrinking from one's duty or dereliction of duty are also forms of corruption. Besides, thefts, wastage of public property constitute varieties of corruption. Dishonesty, exploitation, malpractices, scams, and scandals are various manifestations of corruption.

Questions-

Q20) Kautilya mentions the pressure of how many types of corruption in his contemporary society?

- A) 10
- B) 20
- C) 30
- D) 40

Q21) Perversion of what is not mentioned in the passage?

- A) Attitude
- B) Morality
- C) Character
- D) Integrity

Q22) According to the passage, corruption is \_\_\_\_\_.

- A) prevalent since ancient times
- B) insignificant to Indian society
- C) new phenomenon in India
- D) prevalent only in middle-east countries

Q23) According to the passage, what all are the manifestation of corruption?

- A) Malpractices
- B) Dishonesty
- C) Scams and scandals
- D) All of these

Q24) What is the main reason behind once superstitions?

- A) Fear of the unknown
- B) Blind faith in omens and portents
- C) Ignorance
- D) Customs and traditions

Directions (Questions 25 to 29): Read the following paragraph to answer these questions:

**5 Marks**

Great books do not spring from something accidental in the great men who write them. They are the effluence of their very core, the expression of the life itself of the authors. And literature cannot be said to have served its true purpose until it has been translated into the actual life of him who reads. It is the vast reservoir of true ideas and emotions.

In a world deprived of literature, the broad, the noble, the generous would tend to disappear and life would be correspondingly degraded because the wrong idea and the petty emotion would never feel the upward pull of the ideas and emotions of genius. Only by conceiving a society without literature can it be clearly realized that the function of literature is to raise the plain towards the top level of the peaks.

Literature exists so that where a man has lived finely, ten thousand may afterward live finely. It is a means of life, it concerns the living essence.

Questions-

Q25) How have great books been written?

- A) By men who think too much.
- B) By great men who write them.
- C) By an accidental means.
- D) By men who imagine sometimes.

Q26) What does the words "effluence of their very core" mean?

- A) Expression which is the outflow from the heart of the author.
- B) Expression which is the influence from people's talk.
- C) Expression of things that the author may have thought of.
- D) Expression that the author wrote accidentally.

Q27) Literature cannot be said to have served its true purpose until it has been \_\_\_\_\_ into the actual life of the person who reads.

- A) Transfigured
- B) Transgressed
- C) Translated
- D) Transmuted

Q28) If a world is deprived of literature, what would happen to the broad, the noble and the generous?

- A) They would worry themselves into petty issues.
- B) They would be living a free life without care.
- C) They would tend to disappear and life would be correspondingly degraded.
- D) They would celebrate life.

Q29) What is the function of literature?

- A) To raise everything so that it does not sink to the sea level.
- B) To raise the plain above sea level.
- C) To raise the plain towards the top level of the peaks.
- D) To raise the peaks towards the highest mountain.

Q32 . A rat entered the room from the bottom right corner and saw this scene in front of him. Draw this scene from his point of view.



18 Marks





Q27. Imagine how a bucket and dog will be used in the short story which starts with the sentence **In the backyard of a house, a girl is sitting** .....  
And the story ends with the sentence ..... **at last, the bucket is filled with water.**

18 Marks

Write the story in 150-200 words. -

A) Title of the Story \_\_\_\_\_

Story \_\_\_\_\_

---

---

---

---

---

---

---

---

B) Represent your story through drawing in the given three frames.



Quest<sup>®</sup>

Quizze

Q26 . Shown below is an example where bad public behavior can be seen even after clear instructions are provided. Draw 3 creative solutions of the problem shown in the given boxes. Explain each of your solution in 2-3 lines provided next to the frame. -



18 Marks

	<hr/> <hr/> <hr/> <hr/> <hr/> <hr/>
	<hr/> <hr/> <hr/> <hr/> <hr/> <hr/>
	<hr/> <hr/> <hr/> <hr/> <hr/> <hr/>

Q31. Draw a manual for the following to give instructions on how to use the visual and label in it.

**15 Marks**

- A) Sharpening a pencil
- B) Combing the hair
- C) Cutting nails using nail cutter

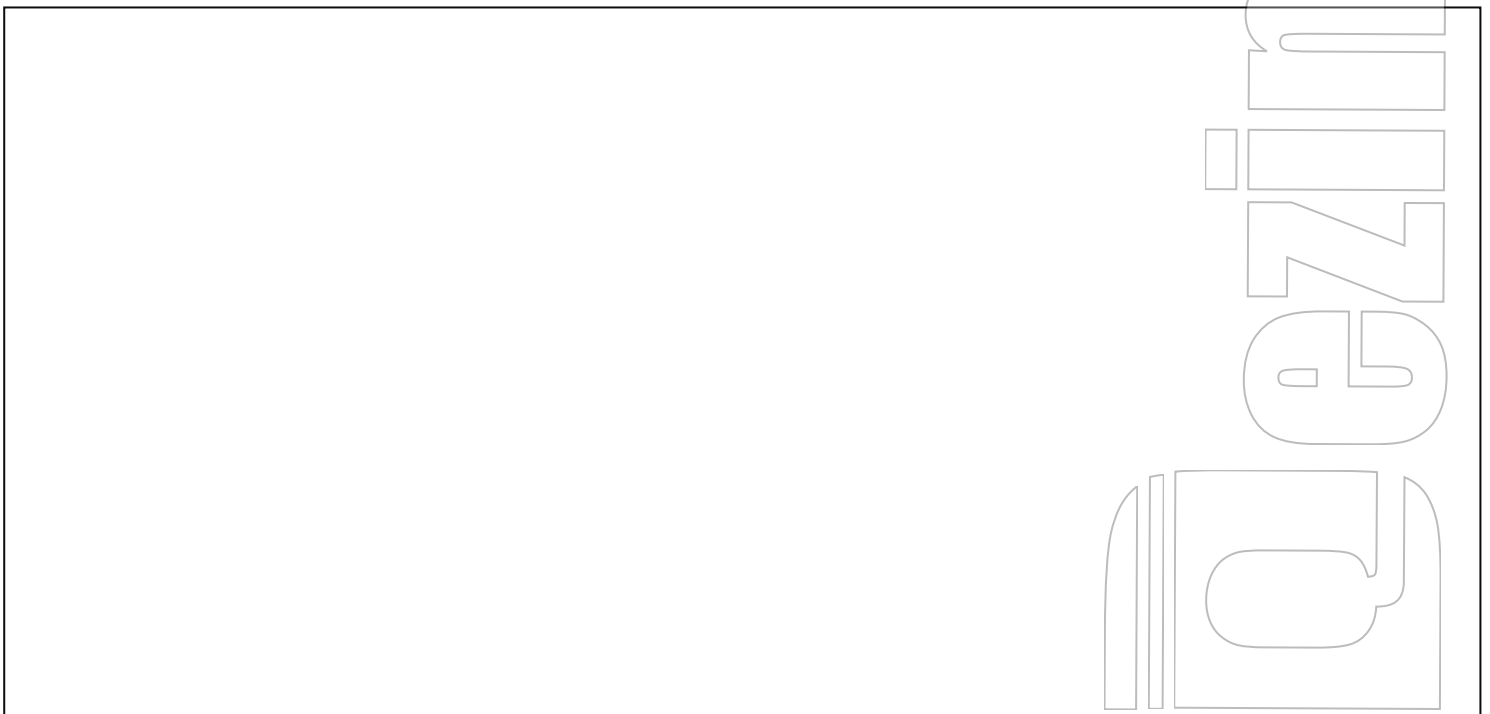
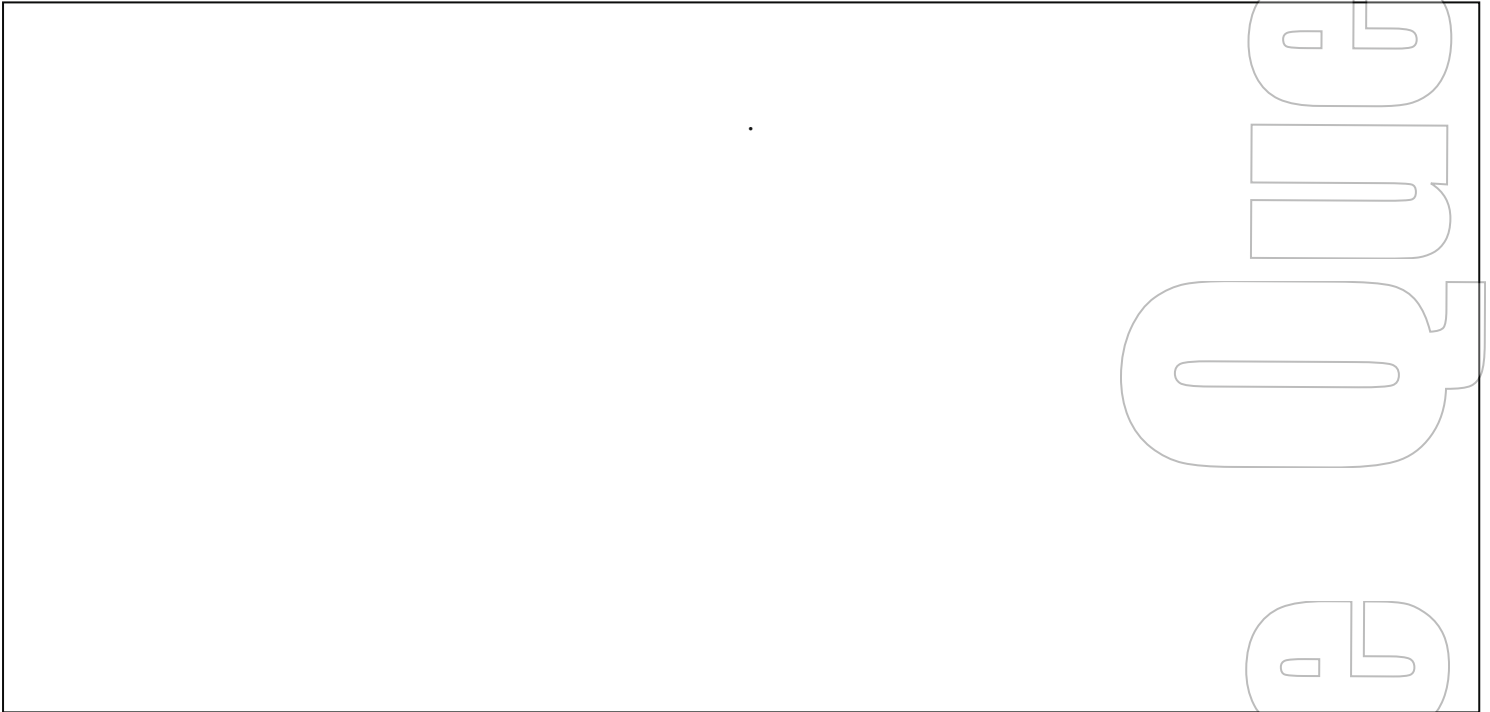

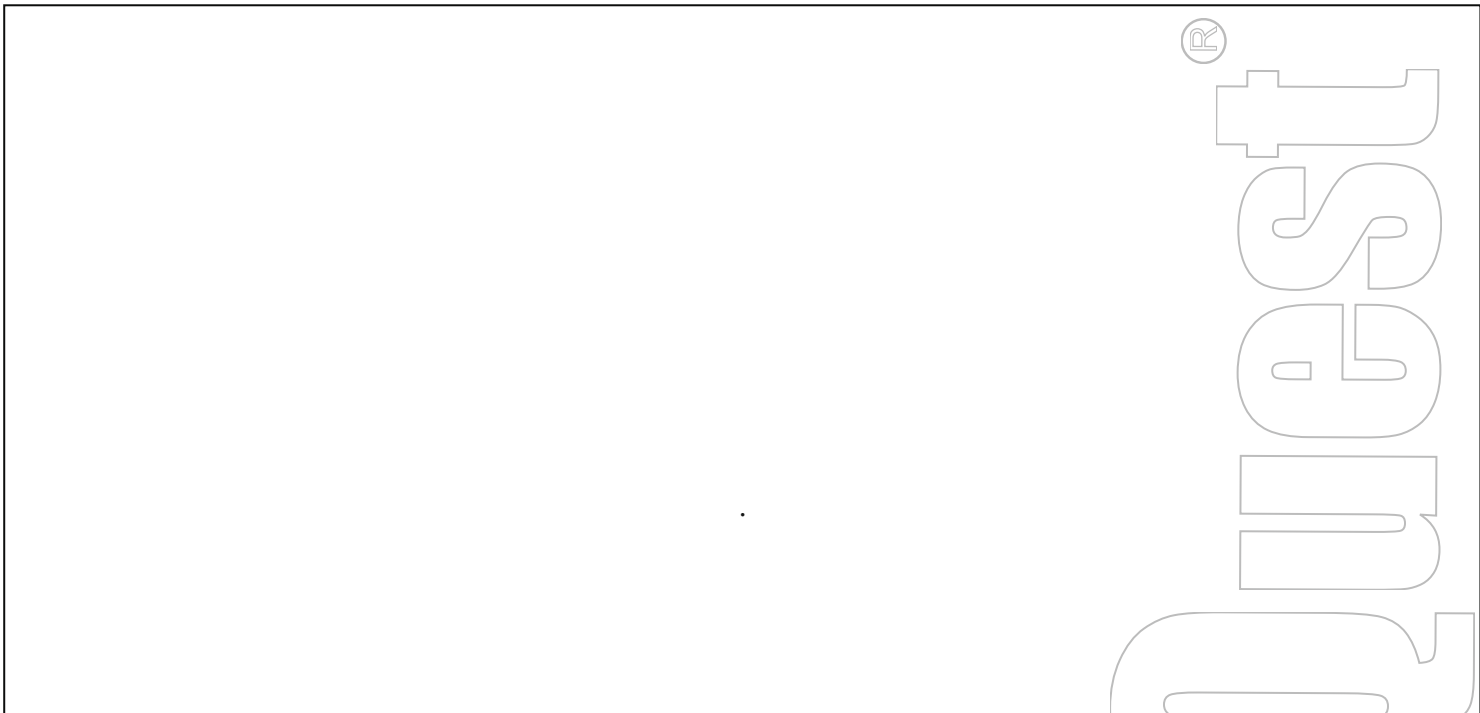

ROUGH

